

Self-Contained Refrigerated Equipment Stands "High Volume Line"

Production Equipment 3000 Series Refrigerated Equipment Stands -



54" LONG
Model : 3054-SR
Ship Weight : 360 lbs.
List Price : **\$ 8462**



76" LONG
Model : 3076-SR
Ship Weight : 490 lbs.
List Price : **\$ 10040**



102" LONG
Model : 3002-SR
Ship Weight : 600 lbs.
List Price : **\$ 12193**

OPTIONS

	3054-SR	3076-SR	3002-SR
Casters	\$ 418	\$ 418	\$ 627
1 Door in place of 2 Drawers	Deduct \$ 375 per door	Deduct \$ 375 per door	Deduct \$ 375 per door
Adjustable Wire Shelf (1 per door)	\$ 429 per door	\$ 429 per door	\$ 429 per door
9 1/2" x 1/2" Richlite Board w/ s/s brackets	\$ 980	\$ 1494	\$ 2162
Full Extension Drawer Slides	\$ 549	\$ 1098	\$ 1647

MECHANICAL DATA

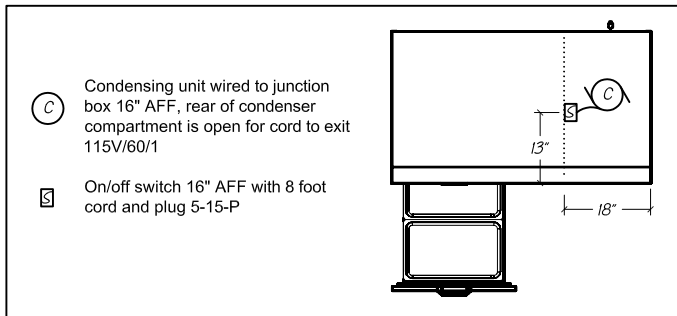

- Notes:**
- i. furnish 15 Amp outlet 20" AFF
 - ii. 3054-SR Model : 1/4-HP-115V-60 Hz-1Ph, total load 6.5 Amp
 - iii. 3076-SR Model : 1/4-HP-115V-60 Hz-1Ph, total load 9.3 Amp
 - iv. 3002-SR Model : 1/3-HP-115V-60 Hz-1Ph, total load 10.9 Amp

SIDE VIEW

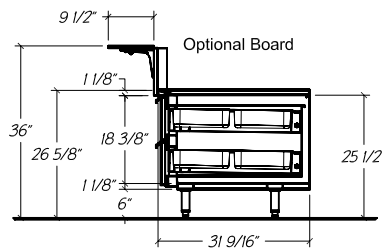

- Standard Features:**
- Self-closing Doors
 - Condensate Evaporator
 - Stainless Steel Ends
 - 6" stainless steel legs
 - All above units class 92.5

- Notes:**
- i. Five years standard compressor warranty add **\$80** net
 - ii. One year labor warranty add **\$225** net
 - iii. For additional info. see spec sheet catalog section 13, pg 2