

Remote Refrigerated Equipment Stands "High Volume Line"

Production Equipment 3100 Series Refrigerated Equipment Stands -



42" LONG
Model : 3142-RR
Ship Weight : 360 lbs.
List Price : \$ 7258



64" LONG
Model : 3164-RR
Ship Weight : 490 lbs.
List Price : \$ 8444



90" LONG
Model : 3190-RR
Ship Weight : 600 lbs.
List Price : \$ 10135

OPTIONS

	3142-RR	3164-RR	3190-RR
Casters	\$ 418	\$ 418	\$ 627
1 Door in place of 2 Drawers	Deduct \$ 375 per door	Deduct \$ 375 per door	Deduct \$ 375 per door
Adjustable Wire Shelf (1 per door)	\$ 429 per door	\$ 429 per door	\$ 429 per door
9 1/2" x 1/2" Richlite Board w/ s/s brackets	\$ 762	\$ 1260	\$ 1909
Full Extension Drawer Slides	\$ 549	\$ 1098	\$ 1647

MECHANICAL DATA

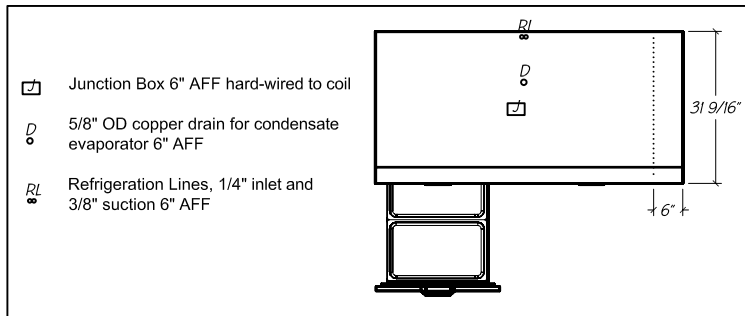

- Notes:**
- i. 3142-RR Model : 115V-60 Hz-1Ph, total load 1.03 Amp
 - ii. 3164-RR Model : 115V-60 Hz-1Ph, total load 1.67 Amp
 - iii. 3190-RR Model : 115V-60 Hz-1Ph, total load 1.67 Amp

SIDE VIEW

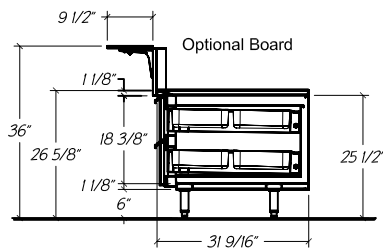

- Standard Features:**
- Self-closing Doors
 - Condensate Evaporator
 - Stainless Steel Ends
 - 6" stainless steel legs
 - All above units class 92.5

Notes: i. For additional info. see spec sheet catalog section 13, pg 2