

# Self-Contained Freezer Equipment Stands "High Volume Line"

## Production Equipment 3200 Series Freezer Equipment Stands -



62" LONG

Model : 3262-SF  
Ship Weight : 350 lbs.  
List Price : \$ 10557



88" LONG

Model : 3288-SF  
Ship Weight : 560 lbs.  
List Price : \$ 12131



116" LONG

Model : 3216-SF  
Ship Weight : 675 lbs.  
List Price : \$ 14280

### OPTIONS

	3262-SF	3288-SF	3216-SF
<b>Casters</b>	\$ 418	\$ 418	\$ 627
<b>1 Door in place of 2 Drawers</b>	Deduct \$ 375 per door	Deduct \$ 375 per door	Deduct \$ 375 per door
<b>Adjustable Wire Shelf (1 per door)</b>	\$ 429 per door	\$ 429 per door	\$ 429 per door
<b>9 1/2" x 1/2" Richlite Board w/ s/s brackets</b>	\$ 1125	\$ 1729	\$ 2409
<b>Full Extension Drawer Slides</b>	\$ 549	\$ 1098	\$ 1647

### MECHANICAL DATA

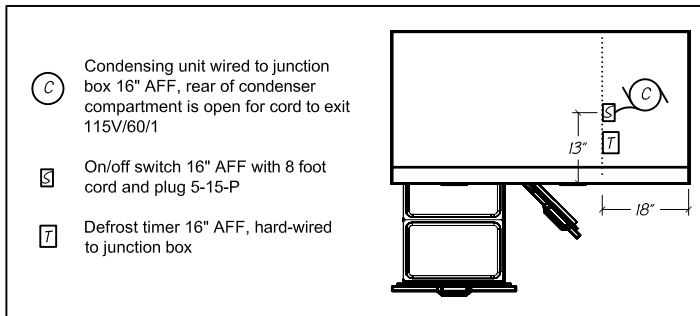

- Notes:**
- i. furnish 15 Amp outlet 20" AFF
  - ii. 3262-SF Model : 1/4-HP-115V-60 Hz-1Ph, total load 6.9 Amp
  - iii. 3288-SF Model : 1/3-HP-115V-60 Hz-1Ph, total load 9.7 Amp
  - iv. 3216-SF Model : 1/2-HP-115V-60 Hz-1Ph, total load 12.6 Amp

### SIDE VIEW

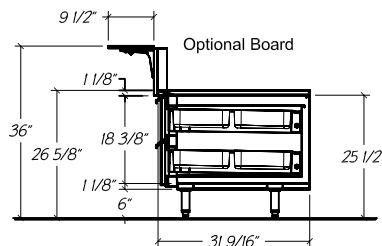

- Standard Features:**
- Self-closing Doors
  - Condensate Evaporator
  - Stainless Steel Ends
  - 6" stainless steel legs
  - All above units class 92.5

- Notes:**
- i. Five years standard compressor warranty 1/4-HP & 1/3-HP add \$80 net, 1/2-HP add \$88 net
  - ii. One year labor warranty add \$225 net
  - iii. For additional info. see spec sheet catalog section 13, pg 3